

BRISTAN

Installation Instructions & User Guide

Please leave these instructions
with the end user

Product Code: CRU TBAS Range (D2)

Specification

Dynamic Water Pressure

Min: 0.5 bar Max: 5.0 bar



Maximum Static Pressure: 10.0 bar

Inlet Water Temperature

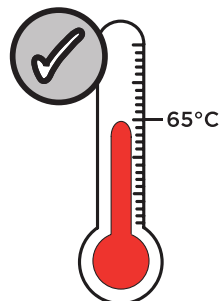

Maximum Hot: 65°C

Inlet Connections

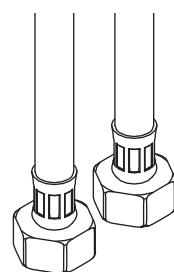

1/2" BSP Flexible Tails

Outlet

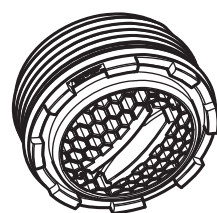

M18.5 5lpm
Coin-Slot Aerator

Pack Contents

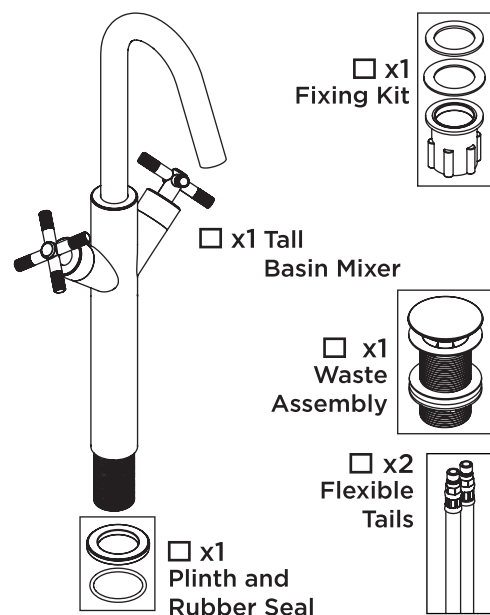

Operation

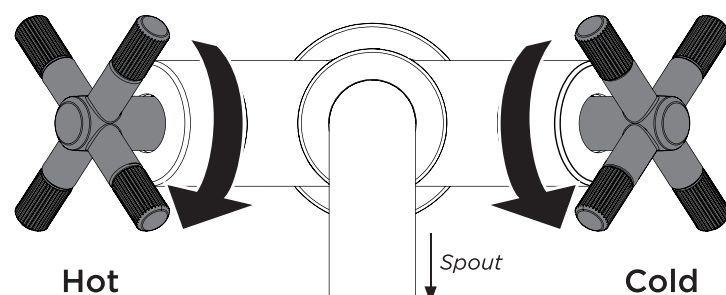

Tools Required



Cross Head
Screwdriver

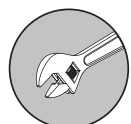

Adjustable
Spanner



17
mm
Socket
Spanner



8
mm
Hex Key



2
mm
Hex Key

Prior to Installation

All products manufactured and supplied by Bristan are safe to use provided that they are installed, operated and receive regular maintenance in accordance with these instructions.

This product needs to be installed in accordance with, and meet the requirements of The Water Supply (Water Fittings) Regulations (Northern Ireland) 2009 and The Water Supply (Water Fittings) (Scotland) Byelaws 2014.

For full Installation Requirements & Notes (IRN) please visit
www.wrasapprovals.co.uk/approvals-directory

Isolation valves must be fitted to the inlet water supplies to ensure ease of future maintenance.

Before installing this product the water supply must be thoroughly flushed in order to remove any swarf, solder etc. Full access must be made available for future maintenance/servicing purposes.

This product must not be modified in any way as this will invalidate the guarantee.

Spare Parts

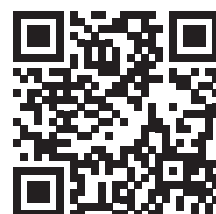

To replace any spare parts
for your tap, scan
the QR Code or visit
www.bristan.com and
search for your product.



PLEASE NOTE - Taps shown in these instructions are for illustration purposes only.
Your product can be installed and maintained using these instructions.

Installation

1

Screw the threaded
tail into the base of
the tap, ensuring
the thread break is
at the top.

Screw in the flexible
tails by hand only.

**DO NOT
OVERTIGHTEN**

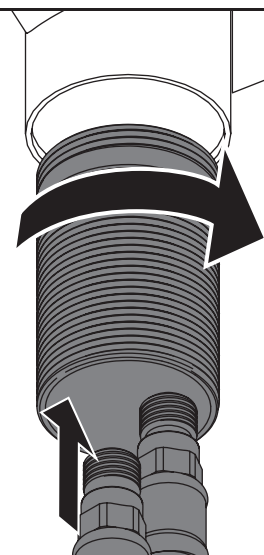

2

Thread the tap and
tails through the
plinth ensuring the
rubber seal is in place.

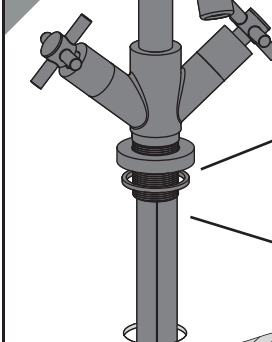

Continue to thread
through the tap hole.

3

Slide the washer and
fixing nut up the
flexible tails and onto
the exposed thread.

Screw the fixing nut
upward until it is tightly
secured against the
mounting surface.

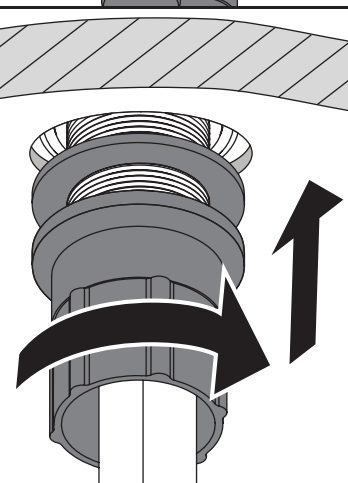

4

Flexible
Tail

Pipe Adaptor

Connect the hot and
cold water supplies
to the flexible tails
and turn until tight.

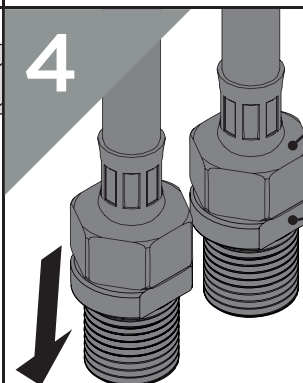

Olive

Nut

Refer to diagram
below for correct
flexible tail position.

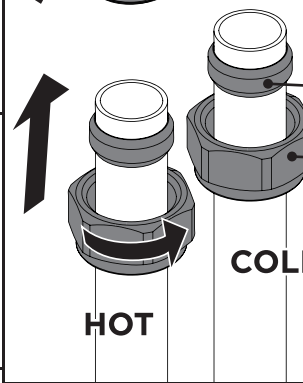

Ensure flexible tails are positioned correctly.

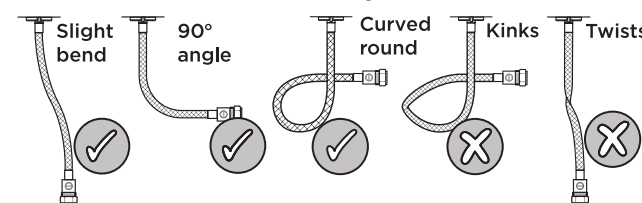

General Cleaning

Bristan products are made from premium
materials, with hand polished, electroplated, PVD
or EPD finishes.

Your taps or shower should be regularly cleaned
with warm water, a mild pH-neutral liquid soap, and
polished with a soft cloth. Any residues from soap,
toothpaste, shampoos and shower gels can cause
blemishes if not rinsed off straight after use.

Household bleaches and cleaners contain harsh
chemicals and may damage the surface finish.
Avoid using abrasive cloths, scouring pads, scrub
sponges, steel wool or anything similar.

5



IMPORTANT
Turn on water
supply for a few
minutes and check
all joints and
connections for
any leaks.

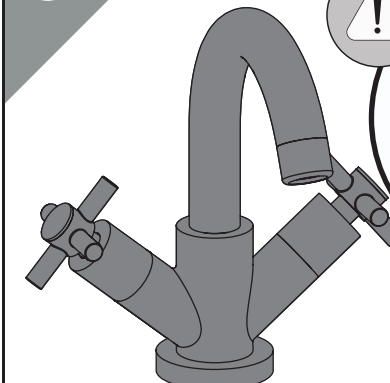

**Your tap is now ready
for use.**

Valve Maintenance - Isolate water supply before starting!

1 Pry off the indice to the reveal the screw.

Remove the screw and washer to loosen the handle.

2 Lift off the handle and unscrew the shroud.

3 Unscrew and remove the valve.

For replacement cartridges, see **SPARE PARTS**.

4 Reverse steps to replace the cartridge.

Waste Installation and Operation

1 Thread the washer onto the waste until it sits tightly under the lip.

Push the waste into the hole until the lip sits flush with the basin.

2 Slide the second washer along the exposed underside of the waste.

Then tighten the backnut to secure in place.

3 Push the centre down to close the waste, push again to open.

Your waste is now ready for use.

Spout Seals Replacement

- Isolate water supply before starting!

1 Remove the grub screw from the rear of the tap and lift out the spout.

2 Unscrew the spout connector. Take note of spout seal positions, then remove them.

3 For replacement seals kit, see **SPARE PARTS**. Apply a WRAS approved grease to the new seals kit.

4 Place the new seals kit onto the spout connector and screw back into tap body. Replace the spout and grub screw.

Outlet Cleaning

1 Insert a coin into the slot in the outlet and twist gently to remove.

(Reverse to replace)

2 Check all loose parts for damage and then soak using a suitable solution to de-scale.

Troubleshooting

Symptom	Cause	Remedy
Low Flow	Partially closed isolation valve.	Open isolation valve.
	Airlock or partial blockage in the supply pipework.	Flush through pipework to ensure removal of debris and any airlocks.
	Partial blockage in the outlet	Remove to Clean and soak in suitable solution.
No hot water or cycling hot and cold	Instantaneous water heater cycles on and off as flow rate or pressure is too low.	Increase water flow rate or pressure through system.
No Flow	Closed isolation valve.	Open isolation valve.
	Mains water supply turned off.	Turn on mains water supply.
Temperatures not corresponding with taps	Inlet pipes have been connected incorrectly	Swap the inlet tails around.

Our Guarantee

At Bristan, we want to make things as easy as possible for our customers. That's why we offer solid guarantees on all our products, effective from the date of purchase, to give you peace of mind.



Your guarantee starts from the purchase of your product, but you can still benefit from registering it for easier identification in the unlikely event of a manufacturing fault, please visit www.bristan.com/register

For any other queries, please call Customer Service on 0330 026 6273 where our expert team of advisors will be able to offer you any help and advice.

For full guarantee terms and conditions visit www.bristan.com/service-centre/guarantees

Contact Us

BRISTAN

Bristan Group Ltd.
A Masco Company

Part of **BRISTAN GROUP**

UK: Bristan Group,
Pooley Hall Drive,
Birch Coppice Business Park,
Dordon, Tamworth
B78 1SG.

EU: Masco Europe S.à.r.l.
14 Rue Strachen
6933 Mensdorf
Luxembourg

Email Us: enquire@bristan.com
Website: www.bristan.com
Call Us: +44330 026 6273