

# K SNK EF BN TO

## COLONIAL Tap Range

Colonial Easyfit Sink Mixer  
Brushed Nickel Tap Only



### Features:

- Product supplied without Easyfit base
- Minimum working pressure of 0.3 bar

### Product Certifications:



WRAS Certificate No: 2109907  
WRAS Expiry Date: 30/09/2026

For more products, visit our website:  
<http://www.bristan.com>

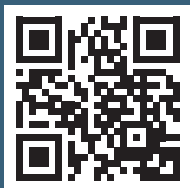

### Specification

Product Type:	Kitchen Taps
Main Construction Material:	Brass
Mount Type:	Deck Mounted
Handle Type:	Crosshead Handles
Connection Inlet:	1/2" BSP Flexible Tails
Connection Outlet:	Open
Number of Tap Holes:	1
Valve/Cartridge Type:	1/2" Compression Valve
Plumbing System Requirements:	Suitable for all plumbing systems
Minimum Dynamic Pressure (bar):	0.3 bar
Maximum Dynamic Pressure (bar):	5.0 bar
Maximum Hot Water Temperature °C:	65°C
Maximum Static Pressure (bar):	10 bar
Flow Type:	Single Flow
Isolation Included:	Yes

### Dimensions (measurements in mm)

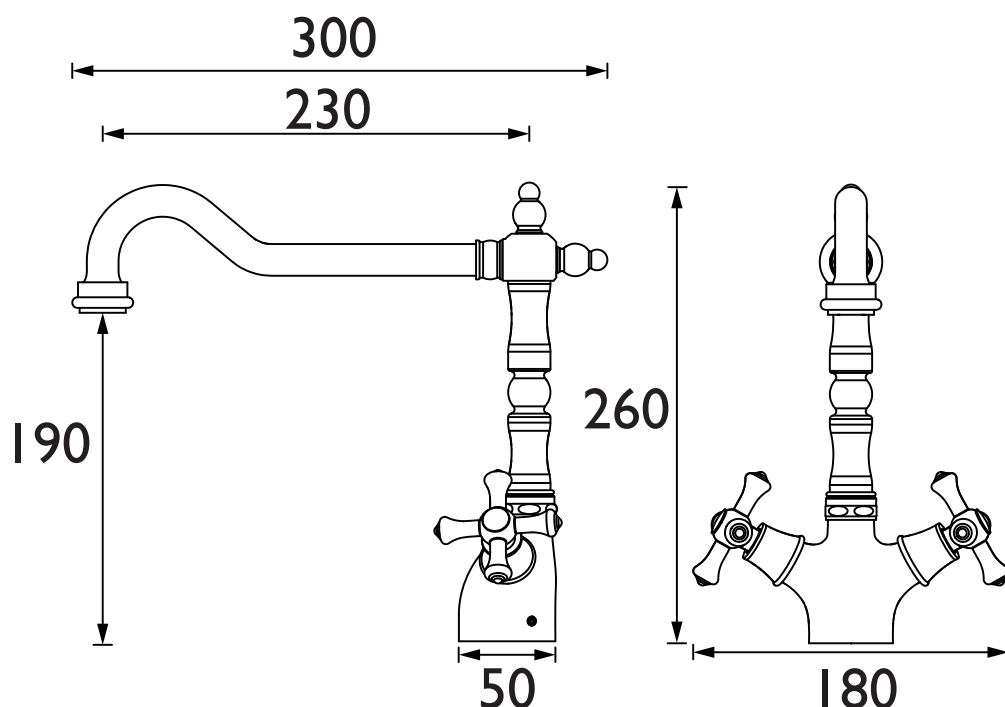

### Flow Rates (l/min)

System Pressure (bar)	0.3	0.5	1	2	3	5
K SNK EF BN TO (mixed)	13.6	17.5	24.8	35.1	42.9	55.4

TECHNICAL  
DATA  
SHEET



**BRISTAN**

D3

Bristan, Birch Coppice Business Park, Dordon, Tamworth, B78 1SG. Web Site: [www.bristan.com](http://www.bristan.com) Telephone: 0330 026 6273. Email: [enquire@bristan.com](mailto:enquire@bristan.com).

\* - 10 year guarantee applies to products purchased on or after 01/04/2021. The information contained on this page was correct at date of issue. Fitting Dimensions are provided as a guide only. Some variation may occur due to manufacturing tolerances. Bristan pursues a policy of continuous improvement in design and performance of its products and so reserves the right to change specifications without prior notice.