

Product Code: QST BSM C

Revision: D3

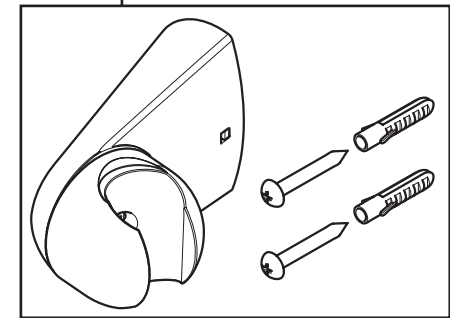
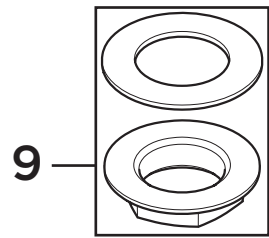
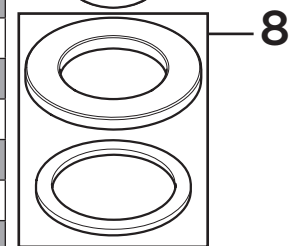
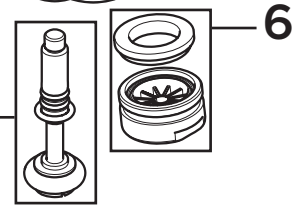
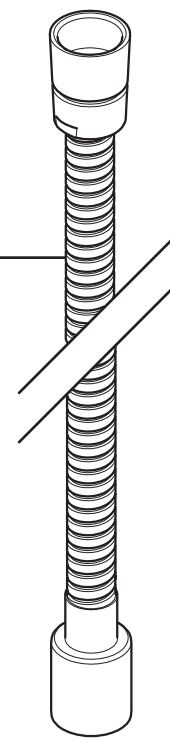
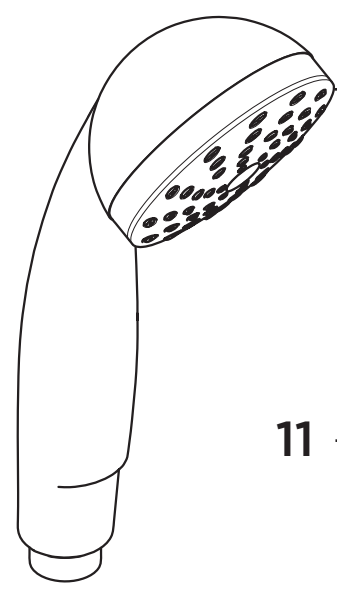
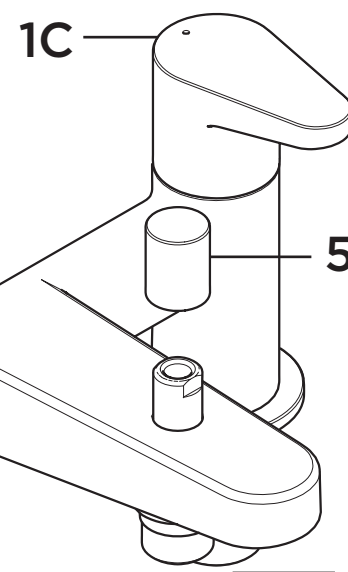
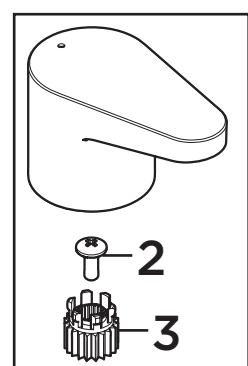
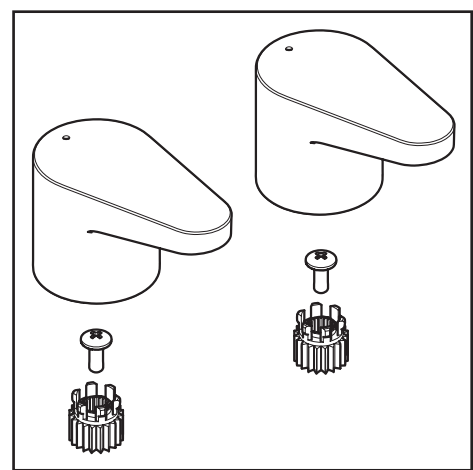

1H	Hot Handle Assembly inc. Spline Adaptor and Screw
1C	Cold Handle Assembly inc. Spline Adaptor and Screw
1P	Handle Assembly (pair) inc. Spline Adaptor and Screw
2	M4x10 Screw
3	Spline Adaptor
4	1/4 Turn 3/4" Ceramic Disc Valves (pair)
5	Diverter Knob
6	Housed M24 Flow Straightener
7	Diverter Mechanism
8	Plinth with Rubber Seal
9	Backnut and Washer
10	Single Function Handset
11	1.7m Cone to Nut Hose
12	Handset Wall Bracket